



Nether Street, West Finchley, N3 1JD
£650,000 Share of Freehold Council Tax Band E

REAL ESTATES
Est. 1981

Estate Agents · Residential Sales · Investments · Lettings

OFFERED CHAIN FREE A 2 bedroom, 2 bathroom (1 en suite) maisonette with the benefit of a PRIVATE REAR GARDEN, OFF STREET PARKING AND SHARE OF FREEHOLD.

The spacious accommodation comprises open plan contemporary fitted kitchen/diner/living area with bi-fold doors opening onto a patio with steps up to decking area and garden, utility room, master bedroom with en suite bathroom, 2nd bedroom and family bathroom.





Nether Street, London, N3

Approximate Area = 1108 sq ft / 102.9 sq m

For identification only - Not to scale

Energy Efficiency Rating		Current	Potential
Very energy efficient - lower running costs			
A	92-100		
B	81-91	76	80
C	69-80		
D	55-68		
E	39-54		
F	21-38		
G	1-20		
Not energy efficient - higher running costs			
EU Directive			

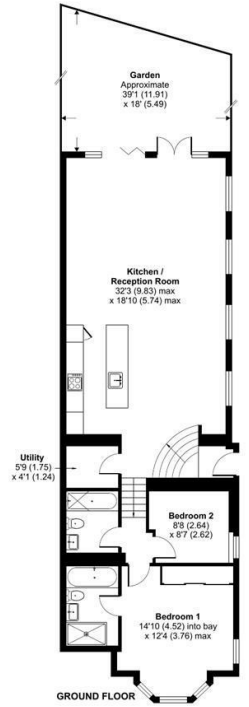

Certified Property Measurer
 Floor plan produced in accordance with RICS Property Measurement Standards incorporating International Property Measurement Standards (IPMS Residential). © ritchcom 2023. Produced for Real Estates - REF: 994792.



Real Estates Woodside Park Office:
 14/14a Sussex Ring
 Woodside Park N12 7HX

ll : 020 8445 6387
 e : info@realestates-wsp.co.uk
 w : www.realestates-wsp.co.uk